

# 318 SERIES

## Wall profile

For use in  
hospitals • airports • shopping centres • rail stations  
• offices • schools

### Features:

- Attractive finish
- SGalvanised steel construction with Nitriflex rubber insert
- Insert colours: black, grey or cream  
Alternative RAL coloured inserts are available - minimum order quantity applies.
- Standard 3 metre legths
- Corner/angle options

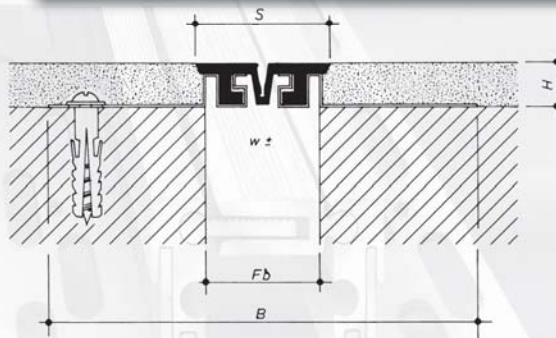
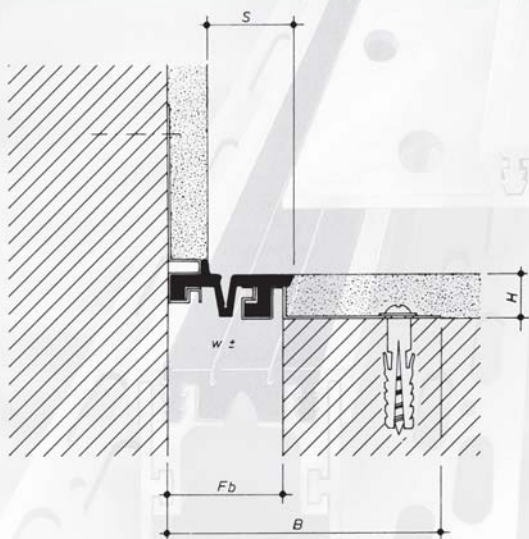
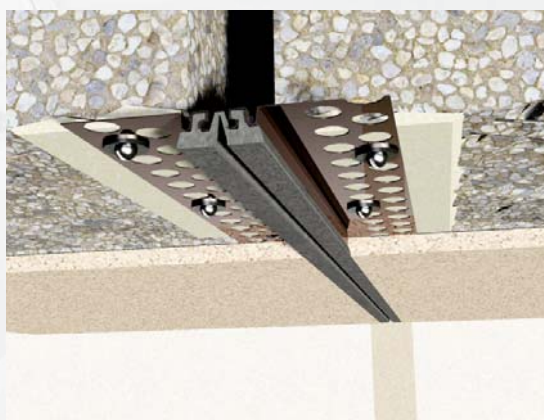

Profile reference	318-030	318-050
Fb - Joint widths upto (mm)	30	50
H - Heights (mm)	11 / 14 / 20	11 / 14 / 20
B - Overall width (mm)	137	163
S - Visible width (mm)	34	115
Movement Total (+/- mm)	7 (+5/-2)	16 (+10/-6)

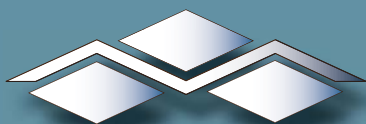

**Movement Joints (UK) Ltd,**  
Unit 3, 57 Thorby Avenue, March, Cambridgeshire PE15 0AZ United Kingdom  
Tel: 01354 60 79 60 Fax: 01354 60 78 33  
Web: [www.mjuk.co.uk](http://www.mjuk.co.uk) e-mail: [info@mjuk.co.uk](mailto:info@mjuk.co.uk)