

## Movement Joints (UK) Ltd

P O Box 10, Wisbech, Cambridgeshire PE13 4AN  
Tel: 01945 450736 Fax: 01945 450819  
Web: www.mjuk.co.uk  
e-mail: info@mjuk.co.uk

## 335 Series

## Facades, Walls & Ceilings

For use with wall insulation

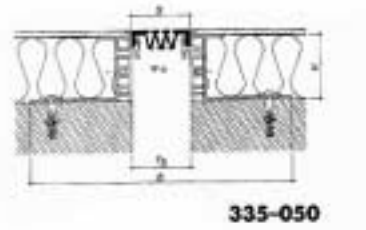

Profile Number	335-030	335-050	335-080	335-120	335-200
Fb - Joint widths up to (mm)	30	50	80	120	200
H - Heights (mm)	42 / 52 / 62 / 72 / 82 / 92 / 102				
B - Overall width (mm)	165	195	215	255	325
S - Visible width (mm)	35	60	90	130	210
Accommodation of movement (mm)	10 (+8/-2)	30 (+20/-10)	45 (+30/-15)	65 (+45/-20)	90 (+50/-40)
Insert Colours	Black, grey				
Material	Besaflex <sup>®</sup> , aluminium				
Standard Length (metres)	4				

**Applications:** For all finishes (Screed, natural stone, cast stone etc)

**Profile characteristics:** Smooth surface, attractive design, high load bearing capacity

**Profile installation:** See tips for planning and installation

**IMPORTANT**

Whilst all reasonable care is taken in compiling technical data on the company's products, all recommendations or suggestions regarding the use of such products are made without guarantee since the conditions of use are beyond the company. It is the customers responsibility to satisfy himself that each product is fit for the purpose for which he intends to use it and that the actual conditions of use are suitable.

